

**TECHNICAL FILE**

**PRODUCT RANGE:** KING

**CODE:** KING-SSA-00

**DESCRIPTION:** SHOWER SEAT WITH ARMRESTS KING

**PRODUCT FEATURES:**

The KING shower seat with armrests is designed for those who want to increase their comfort while showering and carrying out different hygiene operations in the bathroom. The ergonomically designed surface area of the seat reduces pressure, increasing user comfort. The anti-slip pattern of the seat surface prevents sliding during the hygiene operation to ensure maximum safety. The 4 legs are adjustable in height to better fit with the user needs. The seat is made of polypropylene offering durability, strength and warmth. The frame is made of anodized aluminium to ensure the best resistance against corrosion. All the surfaces are easy to clean.

**MECHANICAL PERFORMANCE:**

Max user weight 175 kg; 385 lbs.

**CERTIFICATIONS:**

CE Declaration of conformity of the Regulation (EU) 2017/745 Of the European Parliament and of the Council of medical devices (MDR).

**APPLICABLE NORMS:**

UNI EN 12182; UNI CEI EN ISO 14971; UNI EN 1041:2008+A1:2013; EN 1022:2018; EN 581-2:2015.

**MAINTENANCE:**

Periodically check that fixing fittings conform to initial mounting.  
Clean with water and non-aggressive detergent.  
Do not use abrasive or corrosive products.

**PRODUCT PACKAGING:**

Box dimensions: 301.5X124X516 mm.

Gross Weight: 3.817 kg.

Net Weight: 3.19 kg.

Shipping carton dimensions: 320X804X532 mm.

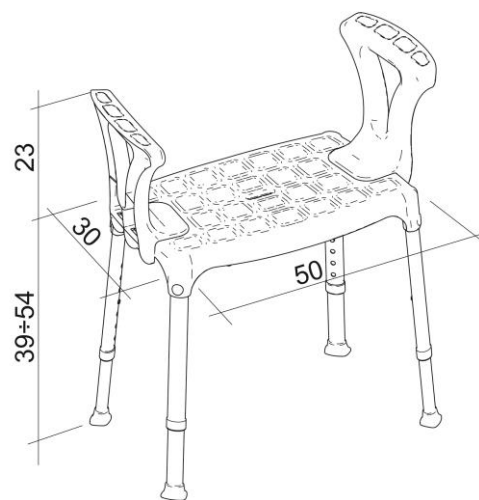

PACKAGING COMPONENTS	Q.TY	CODE
Box	1	RB-KINGSSA-00
Shipping Carton	1/6	SC-KINGSS-00
User Manual	1	UM-KINGSSA-00
Box Label	1	BL-BKINGSSA-00
Shipping Carton Label	1/6	BL-CKINGSSA-00

PRODUCT COMPONENTS	Q.TY	MATERIAL	REF.
Seat	1	Polypropylene 30% CC	1
Kit For Armrest	2	Polypropylene 30% CC	9
External Tube	4	Anodized Aluminium	6
Internal Tube	4	Anodized Aluminium	5
Sliding Part	4	Polyethylene	2
Spring	4	Stainless Steel	4
Plastic Pin	4	Polypropylene	3
Plastic Caps	4	Polypropylene	7
Rubber Caps	4	TPR	8
Locking Clamps	4	Polypropylene	10
Locking Screws	4	Polypropylene	11

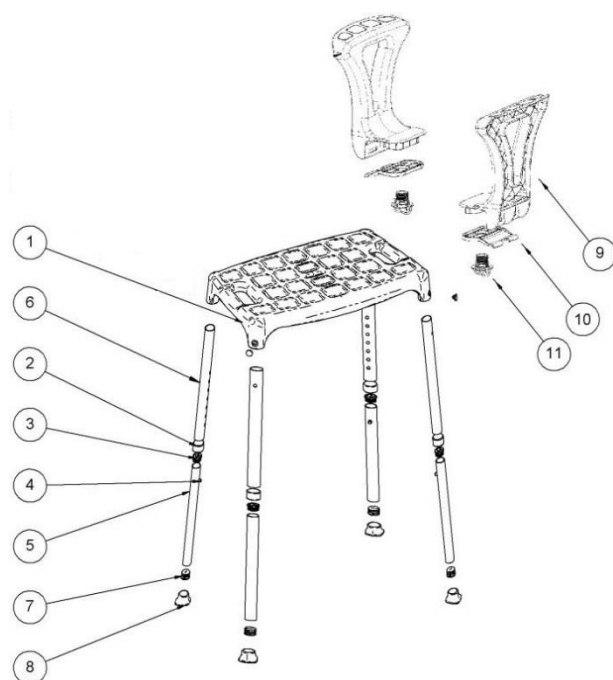

Ref. Technical File KING-SSA-00 Rev 00 as of 12 2020

The above data cannot be binding. LM Global Design Ltd. reserves itself the right to make technical or aesthetic modifications without notice at any time.